

Asking Price £355,000

Juniper Gardens, Southsea PO5 2FN

bernards
THE ESTATE AGENTS



HIGHLIGHTS



We are delighted to present this stunning, two bedroom ground floor apartment in the heart of Central Southsea, complete with secure, gated parking. Thoughtfully restored, the property was once part of the historic St John's College, blending heritage and charm with modern luxury. Situated within the exclusive St John's Square development, the beautiful Sage House comprises five newly converted apartments, each offering high end finishes throughout within a private, secure gated development.

Set within beautifully landscaped gardens, this truly unique two bedroom apartment is bathed in natural light throughout. Accessed via a private entrance, the home opens into an elegant reception hallway, leading seamlessly into a stylish open plan lounge, kitchen, and dining space. The contemporary kitchen is fully fitted with integrated appliances and finished with Caesarstone worktops, perfectly suited to refined modern living. The accommodation is completed by two impressive double bedrooms and a beautifully appointed bathroom featuring a rainfall shower.

Call today to arrange a viewing
02392 864 974
www.bernardsea.co.uk





Call today to arrange a viewing
02392 864 974
www.bernardsestates.co.uk



PROPERTY INFORMATION



Energy Efficiency Rating		Current	Potential
Very energy efficient - lower running costs			
(92 plus) A			
(81-91) B			
(69-80) C			
(55-68) D			
(39-54) E			
(21-38) F			
(1-20) G			
Not energy efficient - higher running costs			
England & Wales		EU Directive 2002/91/EC	



GROUND FLOOR
754 sq.ft. (70.0 sq.m.) approx.

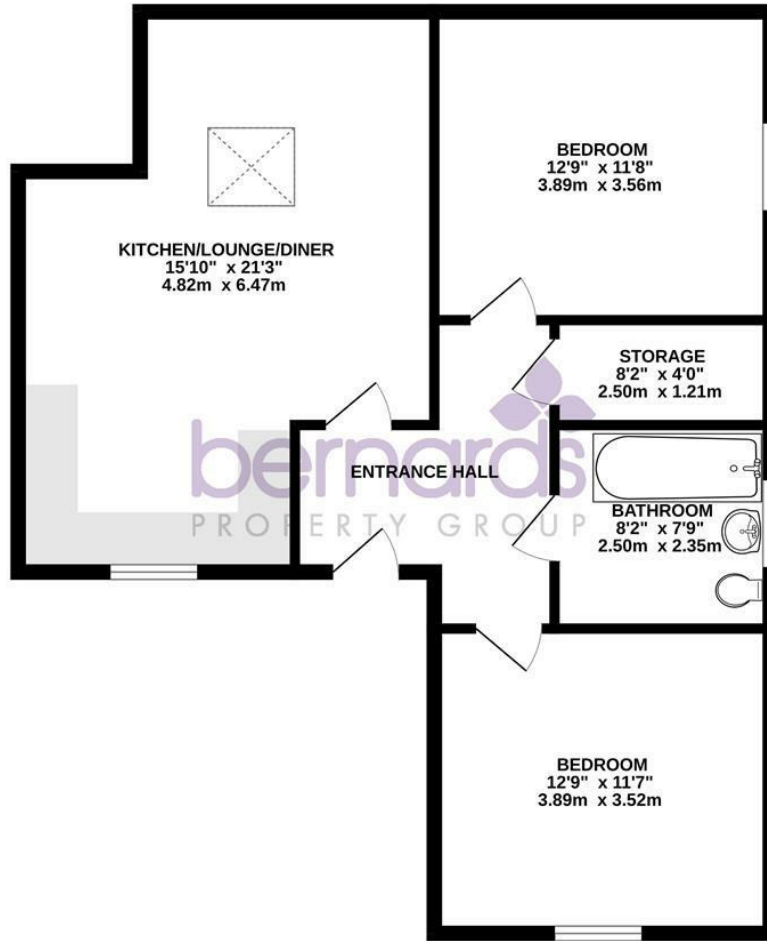

TOTAL FLOOR AREA : 754 sq.ft. (70.0 sq.m.) approx.

Whilst every attempt has been made to ensure the accuracy of the floorplan contained here, measurements of doors, windows, rooms and any other items are approximate and no responsibility is taken for any error, omission or mis-statement. This plan is for illustrative purposes only and should be used as such by any prospective purchaser. The services, systems and appliances shown have not been tested and no guarantee as to their operability or efficiency can be given.
Made with Metropix ©2025

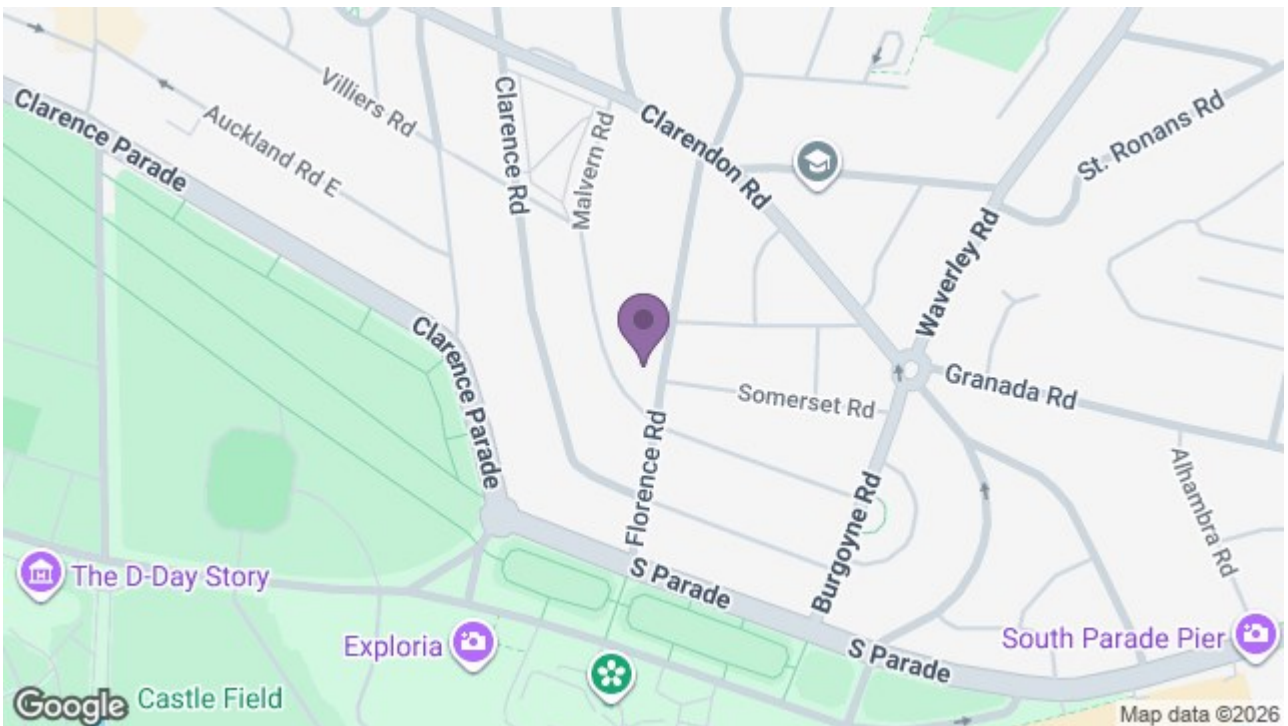

8 Clarendon Road, Southsea, Hampshire, PO5 2EE
t: 02392 864 974

